

What's "Buzzing" at Fazendin?

2022



Fazendin Park Enhancement

Why Enhance Fazendin?

- Increase plant diversity and tree cover
- Attract pollinators, birds, and small mammals to the park
- Decrease use of herbicides and pesticides
- Make Fazendin more environmentally friendly



Fruit Orchard

- Behind 2440, 2430, 2420 Holly Ln N and 2445 Garland Ln N
- Sidewalk for perimeter on west and South edge
- Tree line for perimeter on east and North edge



Why?

- Local fruit
- Attract pollinators
- Add something different to the park



Possible Plantings (Trees)



Frostbite
Apple



Honeycrisp
Apple



La Crescent Plum



Summercrisp Pear



Juicy Jewel Pear



Toka Plum



Red Mulberry



North Star
Cherry



Evans Bali
Cherry

Possible Plantings (Shrubs)

Fall Gold Raspberry



Black Raspberry



Chippewa Blueberry

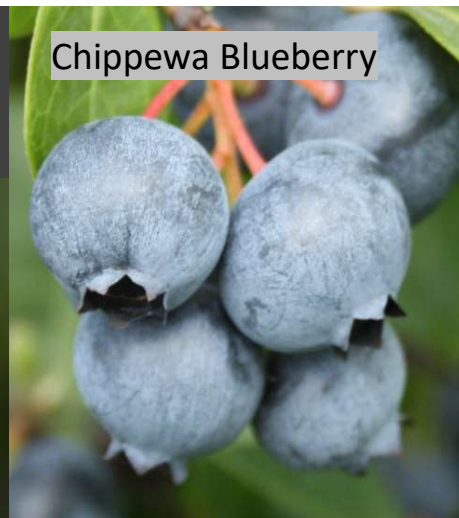

North Country Blueberry



Black Currant



American Cranberry



Heritage Raspberry



Killarney Raspberry



Maintenance

- Signs with names of fruit
- Mulch paths
- Mow between paths
- Mow perimeter near sidewalk and property lines
- Tree guards and other rodent protection



Pollinator Garden

- Behind 17010, 16940, 16930 24th Ave N



Why?

- Increase pollinator populations
- Important to food system
- Attract pollinators to the fruit orchard section
- Native plants



- 33 butterfly/moth species and 5 bee species are on Minnesota's list of, "Species with Greatest Conservation Need"
- Monarch populations have declined by 80% since the 1995
- Bumblebee populations have been declining since 2006
- Causes for pollinator decline include flowerless landscapes, lack of crop and forest diversity, pesticide use, and disease

Human Vision



Pollinator Vision

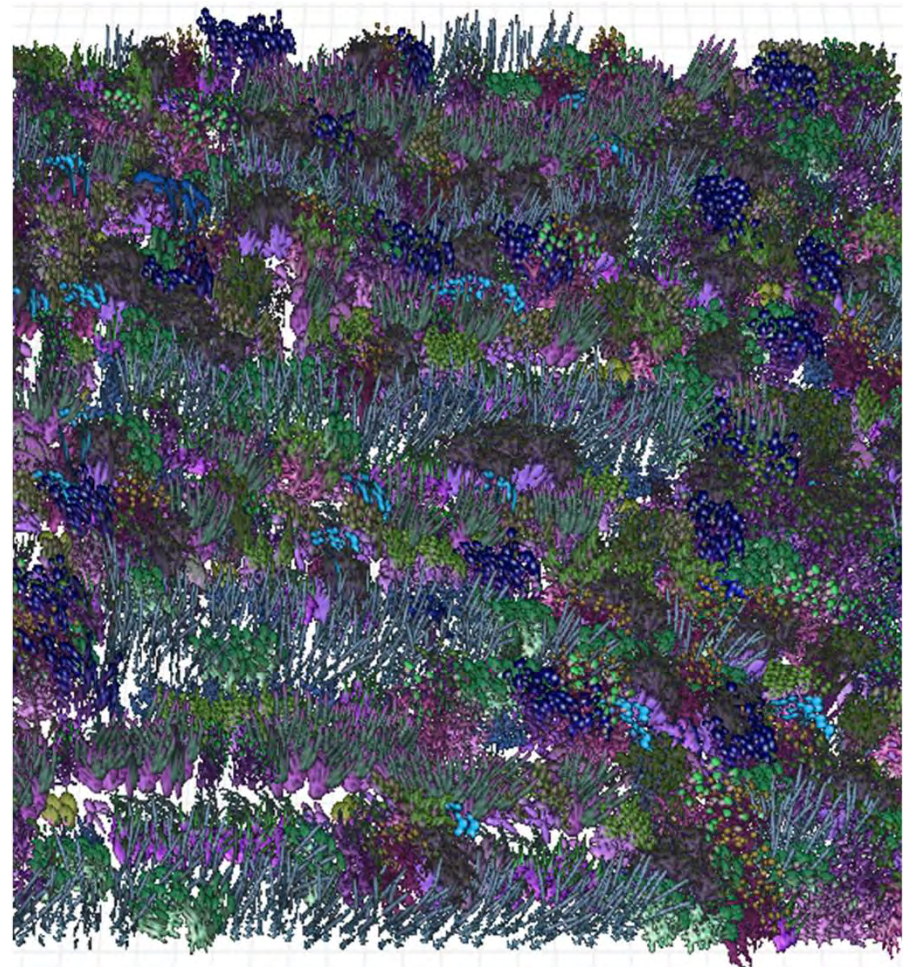

Possible Plantings



Milkweed



Purple Coneflower



Lance Self Heal



Butterfly Weed



Anise Hyssop



Prairie Coreopsis

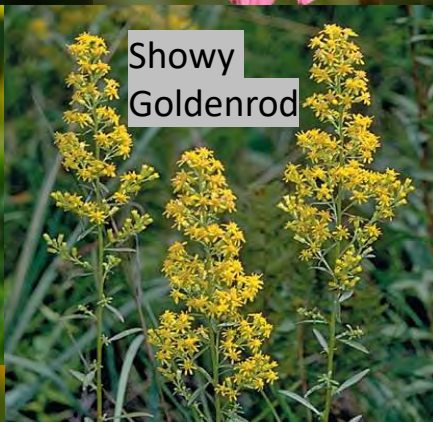

Showy Goldenrod



Smooth Blue Aster



Wild Prairie Rose



Black-eyed Susan



White Sage



Wild Bergamot



Steeplebush



Wild Lupine

Maintenance

- Mow perimeter near sidewalk and private property
- Mow once every spring and burn every 4 years
- Spot treatment of invasive weeds
- Bluebird houses
- Pollinator shelters



Evergreen

- Behind 2435, 2425
Garland Ln N



Why?

- Green all year
- Year-round air filtration
- Winter shelter for birds and mammals
- Fruit shrubs provide food for birds and mammals



Possible Plantings (Trees)

Red
Pine



Eastern
White
Pine



Balsam
Fir



White
Spruce



Eastern
Red
Cedar



Arborvitae



Possible Plantings (Shrubs)



Maintenance

- Mow perimeter near sidewalk and private property
- Mulch around all plantings
- Brush piles for small mammal shelter
- Install bird houses



Nut/Seed Trees

- Behind 2400 and 2410
Garland Ln N and 16815
25th Ave N

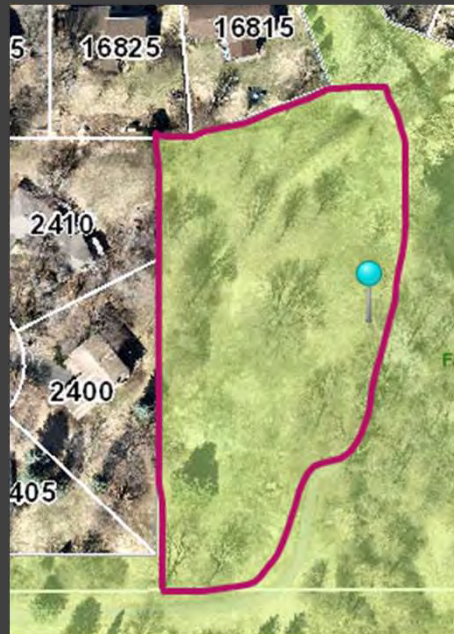

Why?

- Attract mammals and birds
- Add more diversity to Fazendin



Possible Plantings (Overstory)



Bur Oak



White Oak



Northern Red Oak



Bitternut Hickory

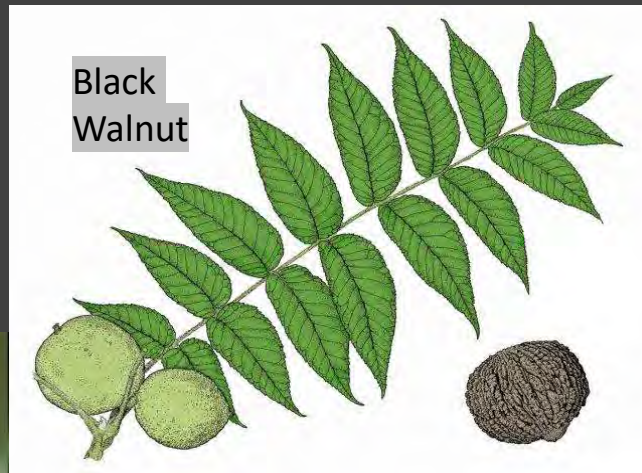

Black Walnut



Black Oak



Shagbark Hickory

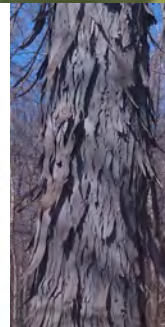

Butternut



American Chestnut

Possible Plantings (Understory)



Maintenance



- Mow perimeter near sidewalk and private property
- Mulch around plantings
- Rodent protection/tree guards
- Bird houses
- Brush piles for small mammal shelter

Review

- Four sections of Fazendin will transition to a fruit orchard, pollinator garden, evergreen area, and an area of nut and seed-bearing trees
- Increase plant diversity
- Increase pollinator populations
- More environmentally friendly park



Fruit Orchard

Pollinator Garden

Evergreen

Nut/Seed Trees

