

Plot Date & Time: 17 October 2011 7:10 AM

\\A012515025 Chelsea Woods\2011 DESIGN PLANS\CA\G-101.dwg

CONSTRUCTION DRAWINGS FOR

CHELSEA WOODS/MEWS

CREEK RESTORATION PROJECT

HENNEPIN COUNTY, MINNESOTA

OCTOBER 2011

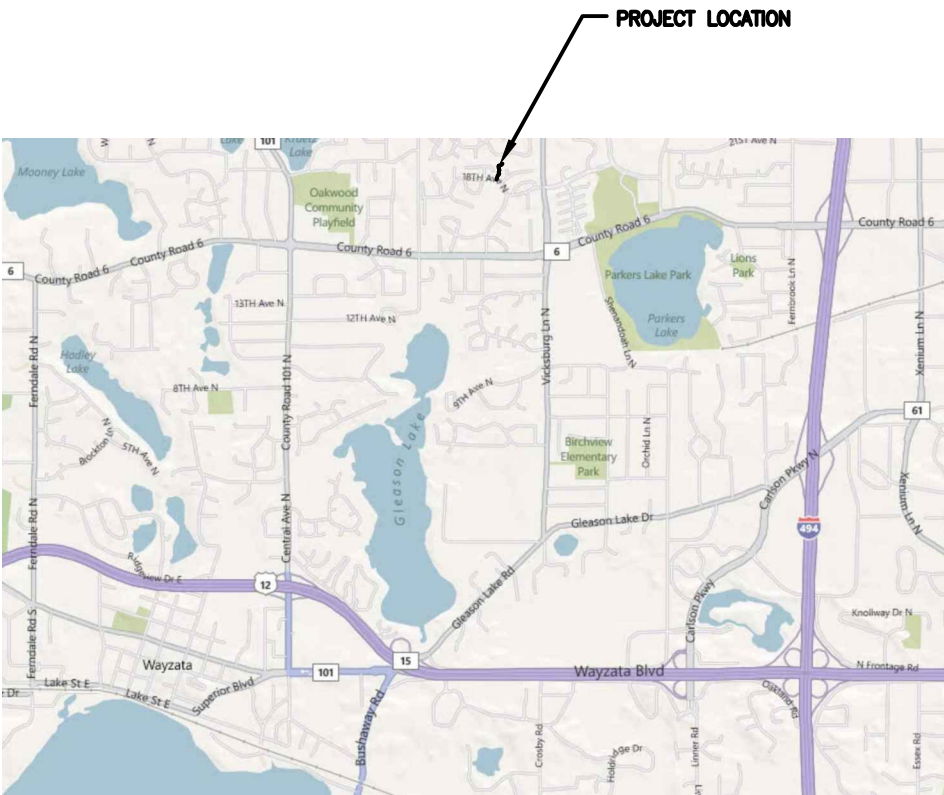

VICINITY MAP

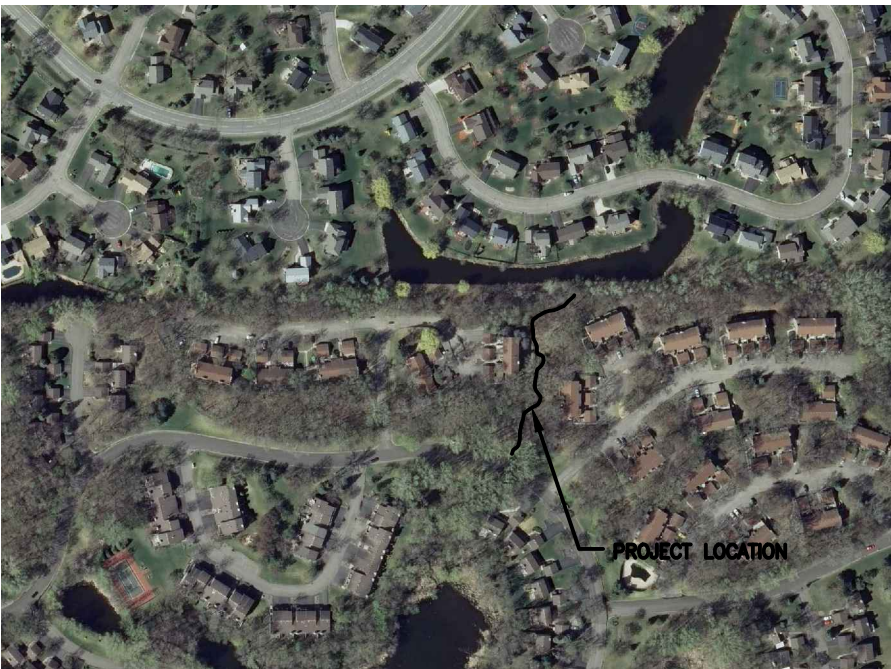

PROJECT LOCATION MAP

INDEX OF SHEETS

G-101	TITLE AND INDEX SHEET
C-101	EXISTING PLAN AND PROFILE ALIGNMENT
C-102	PROPOSED PLAN AND PROFILE ALIGNMENT
C-103	TREE REMOVAL PLAN
C-104	CROSS SECTIONS
D-101	DETAIL PLAN

WARNING:

THE CONTRACTOR SHALL BE RESPONSIBLE FOR CALLING FOR LOCATIONS OF ALL EXISTING UTILITIES. THEY SHALL COOPERATE WITH ALL UTILITY COMPANIES IN MAINTAINING THEIR SERVICE AND/OR RELOCATION OF LINES.

THE CONTRACTOR SHALL CONTACT GOPHER STATE ONE CALL AT 651-454-0002 AT LEAST 48 HOURS IN ADVANCE FOR THE LOCATIONS OF ALL UNDERGROUND WIRES, CABLES, CONDUITS, PIPES, MANHOLES, VALVES OR OTHER BURIED STRUCTURES BEFORE DIGGING. THE CONTRACTOR SHALL REPAIR OR REPLACE THE ABOVE WHEN DAMAGED DURING CONSTRUCTION AT NO COST TO THE OWNER.

CALL BEFORE YOU DIG
GOPHER STATE ONE CALL
TWIN CITY AREA: 651-454-0002
TOLL FREE 1-800-252-1166

REV	REVISION DESCRIPTION	DWN	APP	REV DATE
1	ISSUED FOR FINAL DESIGN	JVB	MP	10/17/11
0	ISSUED FOR REVIEW	JVB	MP	10/13/11

SEAL
I HEREBY CERTIFY THAT THIS PLAN, SPECIFICATION, OR REPORT WAS PREPARED BY ME OR UNDER MY DIRECT SUPERVISION AND THAT I AM A DULY LICENSED PROFESSIONAL ENGINEER UNDER THE LAWS OF THE STATE OF MINNESOTA.
MICHAEL A. PANZER
DATE _____ REG. NO. 15288

PRIME CONSULTANT
 Wenck
© Wenck Associates, Inc. Consulting Engineers 1800 PIONEER CREEK CENTER MAPLE PLAIN, MN 55359
Web Site: www.wenck.com 763-479-420 763-47-4242

PROJECT TITLE
CHELSEA WOODS/MEWS CREEK RESTORATION PROJECT
 MINNEHAHA CREEK WATERSHED DISTRICT QUALITY OF WATER, QUALITY OF LIFE

SHEET TITLE			
TITLE AND INDEX SHEET			
DWN BY JVB	CHK'D MP	APP'D	DWG DATE OCT. 2011
		SCALE AS SHOWN	
PROJECT NO. 0185-5025		SHEET NO. G-101	REV NO. 1

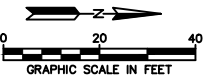

SEAL

I HEREBY CERTIFY THAT THIS PLAN, SPECIFICATION,
OR REPORT WAS PREPARED BY ME OR UNDER MY DIRECT
SUPERVISION AND THAT I AM A DULY LICENSED
PROFESSIONAL ENGINEER UNDER THE LAWS OF THE
STATE OF MINNESOTA.

MICHAEL A. PANZER

DATE _____ REG. NO. _____

© Wenck Associates, Inc.
Consulting Engineers
1800 PIONEER CREEK CENTER
MAPLE PLAIN, MN 55359

Wenck

Web Site: www.wenck.com



MINNEHAHA CREEK
WATERSHED DISTRICT
QUALITY OF WATER, QUALITY OF LIFE

DWN BY JVB	CHK'D MP	APP'D	DWG DATE OCT. 2011
			SCALE AS SHOWN
PROJECT NO. 0185-5025	SHEET NO. C-101		REV NO. 1

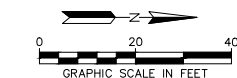

NOTE:
EXISTING 18" RCP TO BE REPLACED BY
CITY OF PLYMOUTH IN 2011-2012.
CONTRACTOR SHALL MATCH NEW CULVERT
INVERT ELEVATION AT 964.3.

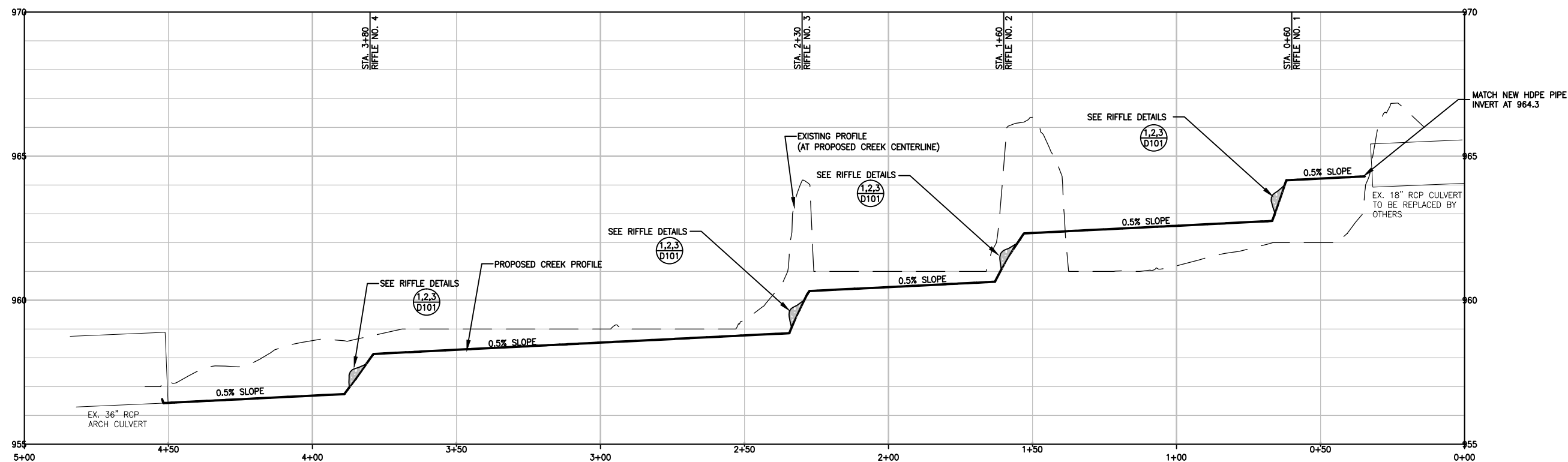

1	ISSUED FOR FINAL DESIGN	KBM	MP	10/17/1
0	ISSUED FOR REVIEW	JVB	MP	8/X/201
REV	REVISION DESCRIPTION	DWN	APP	REV DATE

SEAL

I HEREBY CERTIFY THAT THIS PLAN, SPECIFICATION, OR REPORT WAS PREPARED BY ME OR UNDER MY DIRECT SUPERVISION AND THAT I AM A DULY LICENSED PROFESSIONAL ENGINEER UNDER THE LAWS OF THE STATE OF MINNESOTA.

MICHAEL A. PANZER

DATE _____ REG. NO. _____

PRIME CONSULTANT

 **Wenck**

© Wenck Associates, Inc.
Consulting Engineers

Web Site: www.wenck.com

1800 PIONEER CREEK CENTER
MAPLE PLAIN, MN 55359

763-479-4200
763-479-4242

PROJECT TITLE	<p>CHELSEA WOODS/MEWS CREEK RESTORATION PROJECT</p>
PROJECT NUMBER	
PROJECT LOCATION	
PROJECT DESCRIPTION	
PROJECT STATUS	
PROJECT CONTACT	
PROJECT DATE	
PROJECT BUDGET	
PROJECT FUNDING	
PROJECT TEAM	
PROJECT NOTES	
PROJECT COMMENTS	
PROJECT ACTION PLAN	
PROJECT MONITORING	
PROJECT EVALUATION	
PROJECT REPORT	
PROJECT SUMMARY	
PROJECT CONCLUSION	
PROJECT RECOMMENDATIONS	
PROJECT APPENDIX	
PROJECT GLOSSARY	
PROJECT REFERENCES	
PROJECT ACKNOWLEDGEMENTS	
PROJECT CONTACT INFORMATION	
PROJECT WEBSITE	
PROJECT SOCIAL MEDIA	
PROJECT NEWSLETTER	
PROJECT BLOG	
PROJECT VIDEO	
PROJECT PHOTOGRAPHY	
PROJECT AUDIO	
PROJECT DOCUMENTS	
PROJECT FILES	
PROJECT LINKS	
PROJECT TOOLS	
PROJECT TEMPLATES	
PROJECT RESOURCES	
PROJECT SUPPORT	
PROJECT HELP	
PROJECT FAQ	
PROJECT CONTACT US	
PROJECT ABOUT	
PROJECT HOME	
PROJECT INDEX	
PROJECT SEARCH	
PROJECT FEEDBACK	
PROJECT PRIVACY	
PROJECT TERMS	
PROJECT POLICY	
PROJECT NOTICE	
PROJECT DISCLOSURE	
PROJECT RELEASE	
PROJECT STATEMENT	
PROJECT CERTIFICATE	
PROJECT AWARD	
PROJECT HONORARY	
PROJECT MEMORIAL	
PROJECT DEDICATION	

SHEET TITLE			
<p style="text-align: center;">PROPOSED PLAN AND PROFILE ALIGNMENT</p>			
DWN BY KBM	CHK'D MP	APP'D	DWG DATE OCT. 2011
PROJECT NO.		SCALE	AS SHOWN
0185-5025	SHEET NO.	C-102	REV NO. 1

Tree Removal List

FID	Tree Species	DBH (inches)
4	Ironwood	9.87
6	Ironwood	4.46
7	Ironwood	5.73
8	Ironwood	3.18
9	Ironwood	3.82
10	Ironwood	3.18
11	Ironwood	5.1
12	Ironwood	6.05
13	Ironwood	4.78
14	American Elm	9.24
15	American Elm	4.78
16	Ironwood	5.41
17	Ironwood	3.82
22	Ironwood	4.78
23	Ironwood	4.14
24	Ironwood	4.78
25	Ironwood	3.5
26	Basswood	8.92
27	Ironwood	3.82
30	Ironwood	4.78
31	American Elm	7.96
32	Ironwood	3.82
33	Ironwood	3.5
39	Boxelder	2.87
40	Cottonwood	15.61
67	Ironwood	4.46
68	Ironwood	8.28
75	American Elm	1.59
77	Ironwood	4.46
78	Ironwood	3.18
79	Ironwood	4.46
83	American Elm	3.82
84	Spruce	2.55
94	Ironwood	3.82
95	Ironwood	2.23
96	Bur Oak	21.66
100	Basswood	13.69
102	American Elm	1.91
109	Cottonwood	11.15

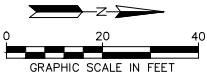
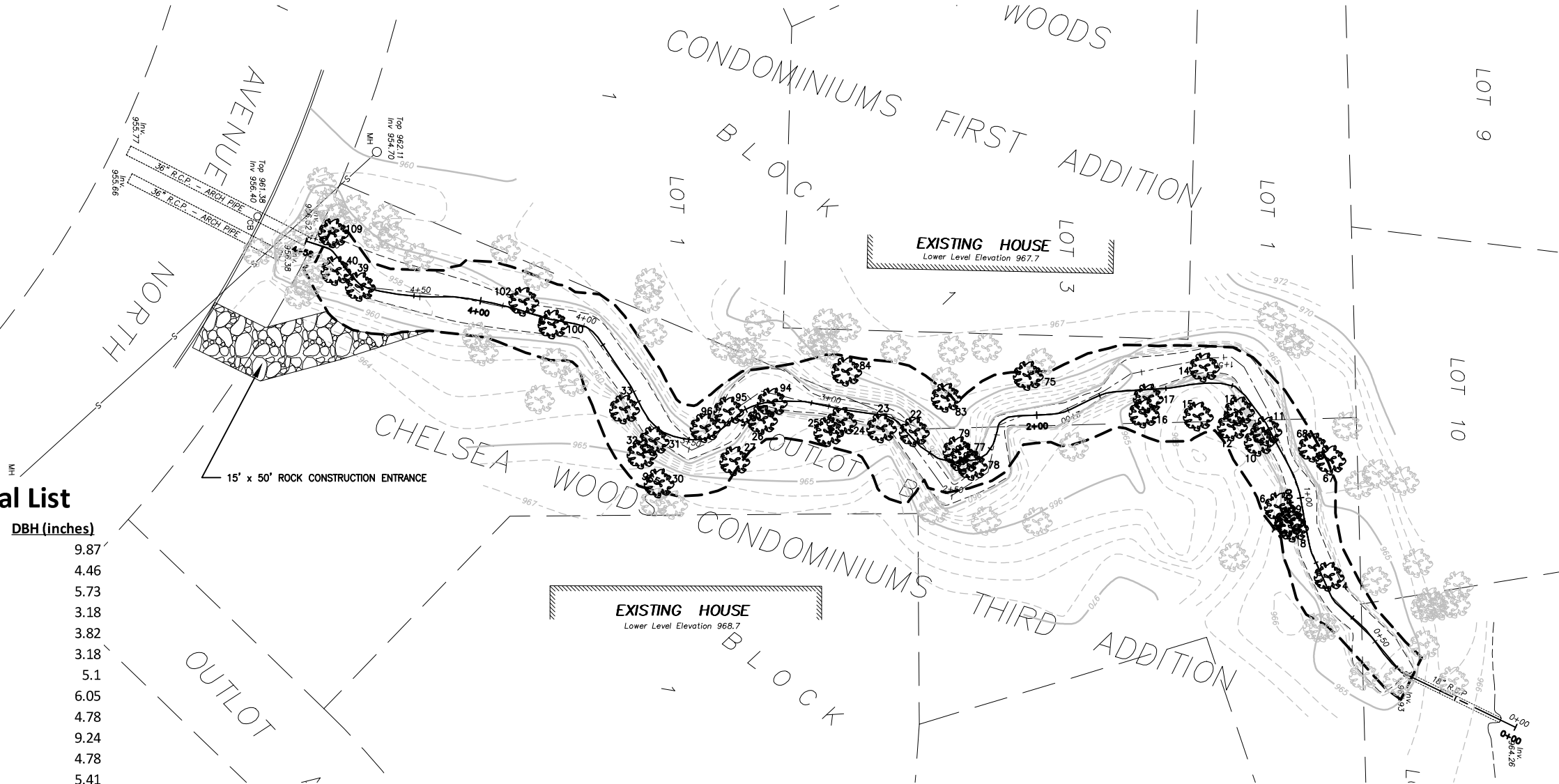

LEGEND

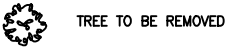

REV	REVISION DESCRIPTION	DWN	APP	REV DATE
1	ISSUED FOR FINAL DESIGN	KBM	MP	10/17/11
0	ISSUED FOR REVIEW	JVB	MP	8/X/2011

SEAL

I HEREBY CERTIFY THAT THIS PLAN, SPECIFICATION, OR REPORT WAS PREPARED BY ME OR UNDER MY DIRECT SUPERVISION AND THAT I AM A DULY LICENSED PROFESSIONAL ENGINEER UNDER THE LAWS OF THE STATE OF MINNESOTA.

MICHAEL A. PANZER

DATE _____ REG. NO. _____

PRIME CONSULTANT

 **Wenck**

© Wenck Associates, Inc.
Consulting Engineers
1800 PIONEER CREEK CENTER
MAPLE PLAIN, MN 55359

Web Site: www.wenck.com
763-479-4200
763-479-4242

PROJECT TITLE
CHelsea Woods/MEWS
CREEK RESTORATION PROJECT

 **MINNEHAHA CREEK
WATERSHED DISTRICT**
QUALITY OF WATER, QUALITY OF LIFE

SHEET TITLE TREE REMOVAL PLAN			
DWN BY JVB	CHK'D MP	APP'D	DWG DATE OCT. 2011
PROJECT NO. 0185-5025		SCALE AS SHOWN	
SHEET NO. C-103		REV NO. 1	

Plot Date & Time: 17 October 2011 2:26 PM
\\A01251\5025 Chelsea Woods\2011 DESIGN PLANS\C-104.dwg

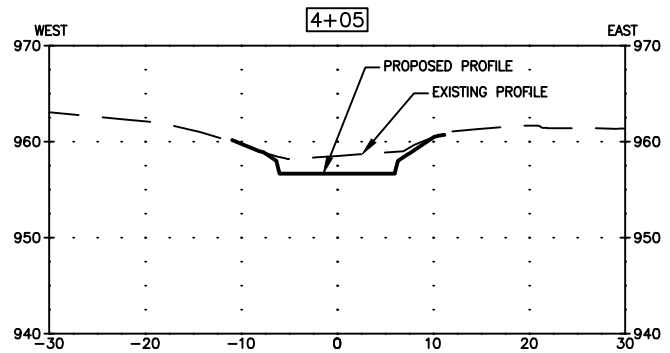
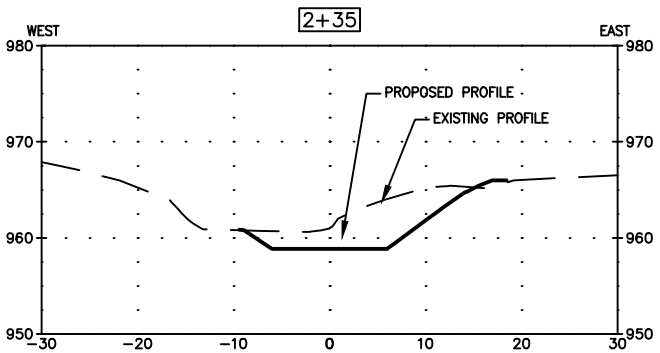
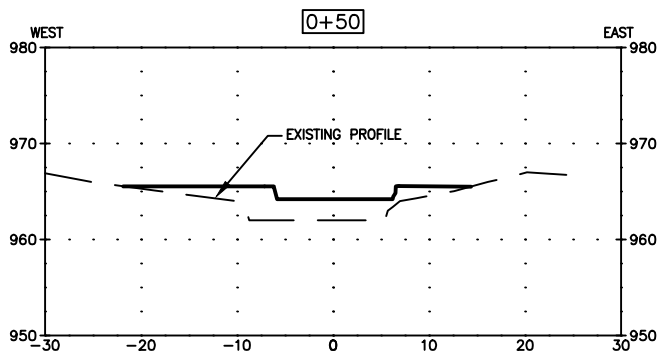
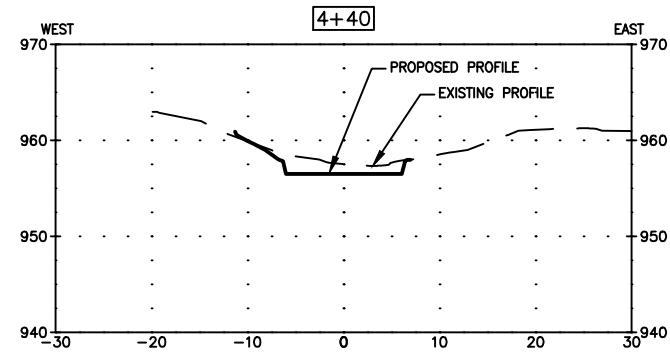
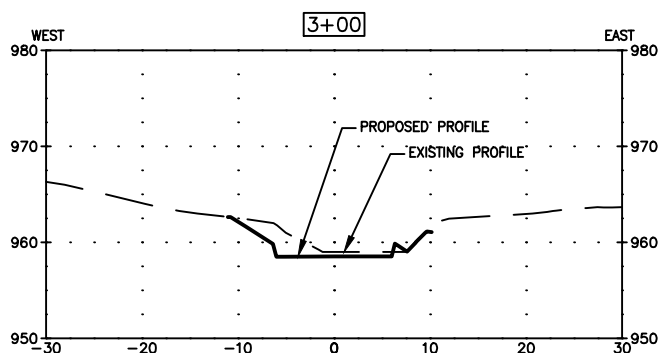
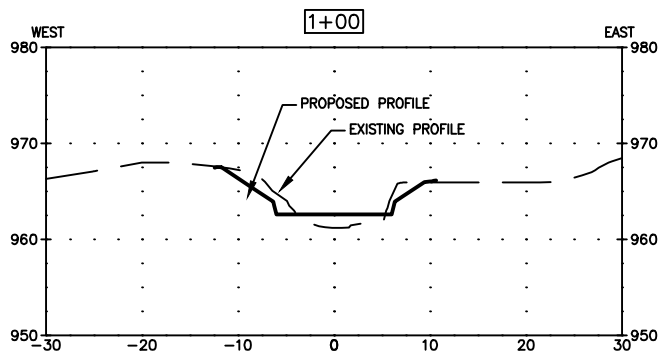
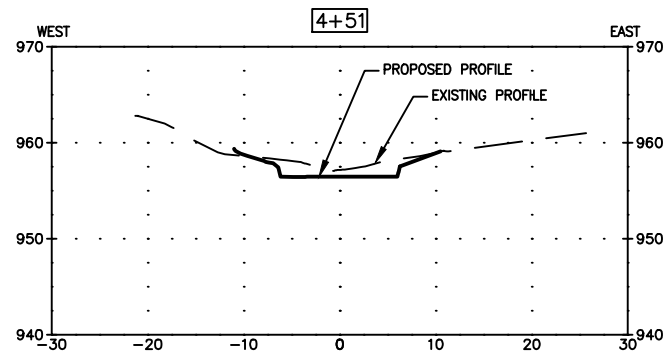
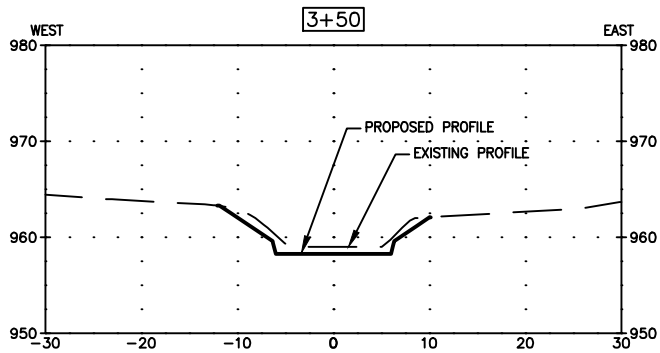
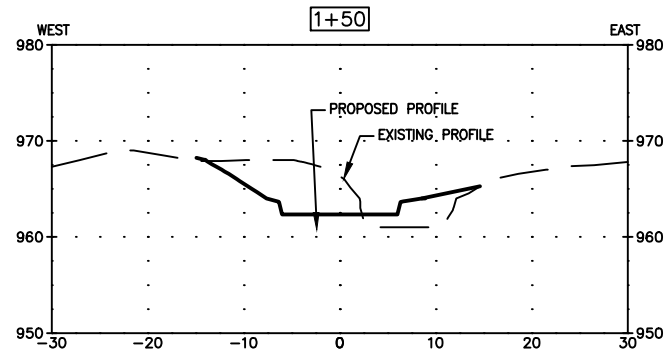
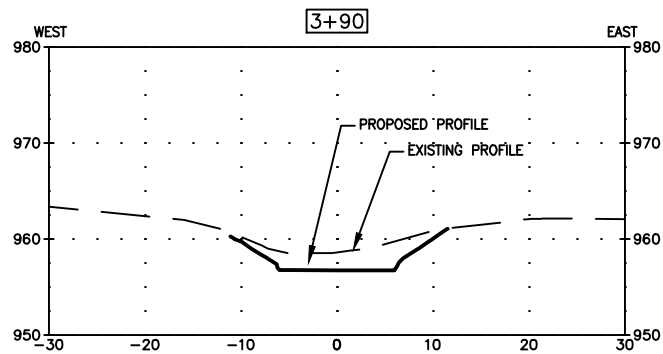
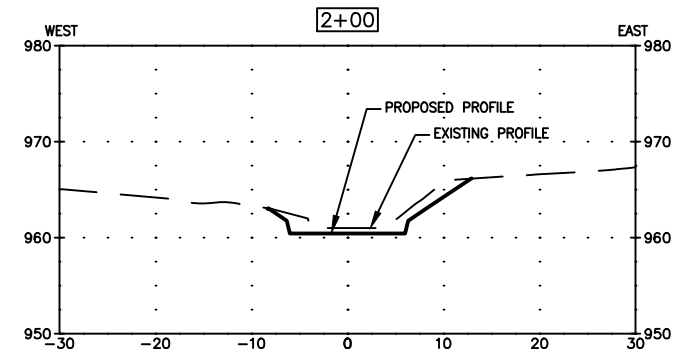

REV	REVISION DESCRIPTION	DWN	APP	REV DATE
1	ISSUED FOR FINAL DESIGN	JVB	MP	10/17/11
0	ISSUED FOR REVIEW	JVB	MP	8/X/2011

SEAL

I HEREBY CERTIFY THAT THIS PLAN, SPECIFICATION, OR REPORT WAS PREPARED BY ME OR UNDER MY DIRECT SUPERVISION AND THAT I AM A DULY LICENSED PROFESSIONAL ENGINEER UNDER THE LAWS OF THE STATE OF MINNESOTA.

MICHAEL A. PANZER

DATE _____ REG. NO. _____

PRIME CONSULTANT

 **Wenck**

Wenck Associates, Inc.
Consulting Engineers
1800 PIONEER CREEK CENTER
MAPLE PLAIN, MN 55359

Web Site: www.wenck.com
763-479-4200
763-479-4242

PROJECT TITLE
CHELSEA WOODS/MEWS
CREEK RESTORATION PROJECT

 **MINNEHAHA CREEK
WATERSHED DISTRICT**
QUALITY OF WATER, QUALITY OF LIFE

SHEET TITLE			
CROSS SECTIONS			
DWN BY JVB	CHK'D MP	APP'D	DWG DATE OCT. 2011
PROJECT NO. 0185-5025	SHEET NO. C-104	SCALE AS SHOWN	
			REV NO. 1

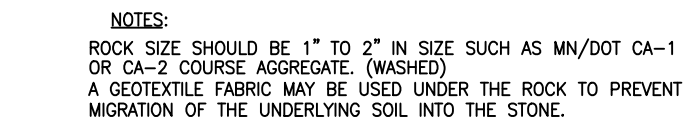

1. INSTALL SILT FENCE PER PLAN SET BEFORE BEGINNING CONSTRUCTION
2. INSTALL SILT FENCE AND EROSION CONTROL BLANKET BEHIND CURB & GUTTER AS SHOWN
3. REPLACE TORN, OVERBURDENED, OR DECOMPOSING SILT FENCE WITHIN 24 HOURS
4. TO JOIN SECTIONS OF SILT FENCE, POSITION POSTS TO OVERLAP. FABRIC SHOULD FOLD AROUND EACH POST ONE FULL TURN



1	ISSUED FOR FINAL DESIGN	KBM	MP	10/17/11					
0	ISSUED FOR REVIEW	JVB	MP	8/X/2011					
REV	REVISION DESCRIPTION	DWN	APP	REV DATE					

SEAL

I HEREBY CERTIFY THAT THIS PLAN, SPECIFICATION,
OR REPORT WAS PREPARED BY ME OR UNDER MY DIRECT
SUPERVISION AND THAT I AM A DULY LICENSED
PROFESSIONAL ENGINEER UNDER THE LAWS OF THE
STATE OF MINNESOTA.

MICHAEL A. PANZER

PRIME CONSULTANT



© Wenck Associates, Inc.
Consulting Engineers
1800 PIONEER CREEK CENTER
MADISON, MN 53760

Wenck
Site: www.wenck.com

Web Site: www.wenck.com

PROJECT TITLE	CHelsea WOODS/MEWS CREEK RESTORATION PROJECT
---------------	---



MINNEHAHA CREEK
WATERSHED DISTRICT
QUALITY OF WATER. QUALITY OF LIFE.

SHEET TITLE	
-------------	--

DETAIL PLAN

DWN BY	CHK'D	APP'D	DWG DATE	OCT. 2011
--------	-------	-------	----------	-----------

KBM	MP		SCALE	AS SHOWN
PROJECT NO.		SHEET NO.		REV NO.

0185-5025	D-101	1
-----------	-------	---