

PLAN SYMBOLS

STATE LINE.
COUNTY LINE.
TOWNSHIP OR RANGE LINE.
SECTION LINE.
QUARTER LINE.
SIXTEENTH LINE.
RIGHT-OF-WAY LINE.
PRESENT RIGHT-OF-WAY LINE.
CONTROL OF ACCESS LINE.
PROPERTY LINE (Except Land Lines).
VACATED PLATTED PROPERTY.
CORPORATE OR CITY LIMITS.

TRUNK HIGHWAY CENTER LINE.
RETAINING WALL.
RAILROAD.
RAILROAD RIGHT-OF-WAY LINE.
RIVER OR CREEK.

DRY RUN.
DRAINAGE DITCH.
DRAIN TILE.
CULVERT.
DROP INLET.
GUARD RAIL.
BARBED WIRE FENCE.
WOVEN WIRE FENCE.
CHAIN LINK FENCE.
RAILROAD SNOW FENCE.
STONE WALL OR FENCE.
HEDGE.
RAILROAD CROSSING SIGN.
RAILROAD CROSSING BELL.
ELECTRIC WARNING SIGN.
CROSSING GATE.
MEANDER CORNER.

SPRINGS.

MARSH.

TIMBER
ORCHARD
BRUSH
NURSERY

CATCH BASIN.
FIRE HYDRANT.

GATE VALVE.

SANITARY SEWER MANHOLE.

STORM SEWER MANHOLE.

OVERPASS (Highway Over).

UNDERPASS (Highway Under).

BRIDGE.

BUILDING (One Story Frame).

F-FRAME C-CONCRETE
S-STONE T-TILE
B-BRICK ST-STUCCO

IRON PIPE OR ROD.

MONUMENT (STONE, CONCRETE, OR METAL).

WOODEN HUB.

GRAVEL PIT.

ROCK QUARRY.

MAILBOX.

SIGN.

UTILITY SYMBOLS

POWER POLE LINE.

TELEPHONE OR TELEGRAPH

POLE LINE.

JOINT TELEPHONE AND POWER

ON POWER POLES

ON TELEPHONE POLES

POWER POLE

ANCHOR

STEEL TOWER

STREET LIGHT

PEDESTAL (TELEPHONE CABLE TERMINAL)

GAS MAIN

WATER MAIN

CONDUIT

TELEPHONE CABLE IN CONDUIT

ELECTRIC CABLE IN CONDUIT

TELEPHONE MANHOLE

ELECTRIC MANHOLE

BURIED TELEPHONE CABLE

BURIED ELECTRIC CABLE

BURIED TELEVISION CABLE

BURIED FIBER OPTIC

SEWER, (SANITARY)

SEWER, (STORM)

SEWER MANHOLE

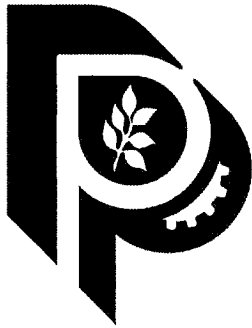
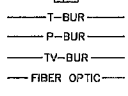
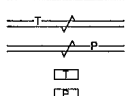
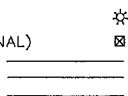
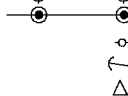
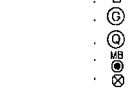
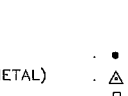
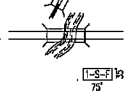
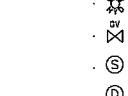
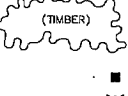
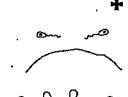
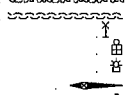
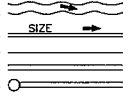
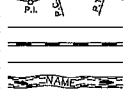
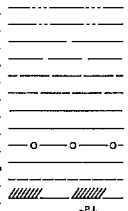

CITY OF PLYMOUTH

HENNEPIN COUNTY, MINNESOTA

CONSTRUCTION PLANS FOR :

DRAINAGE IMPROVEMENTS

ST. MARY'S DRAINAGE IMPROVEMENT

CITY PROJECT NO. 12026

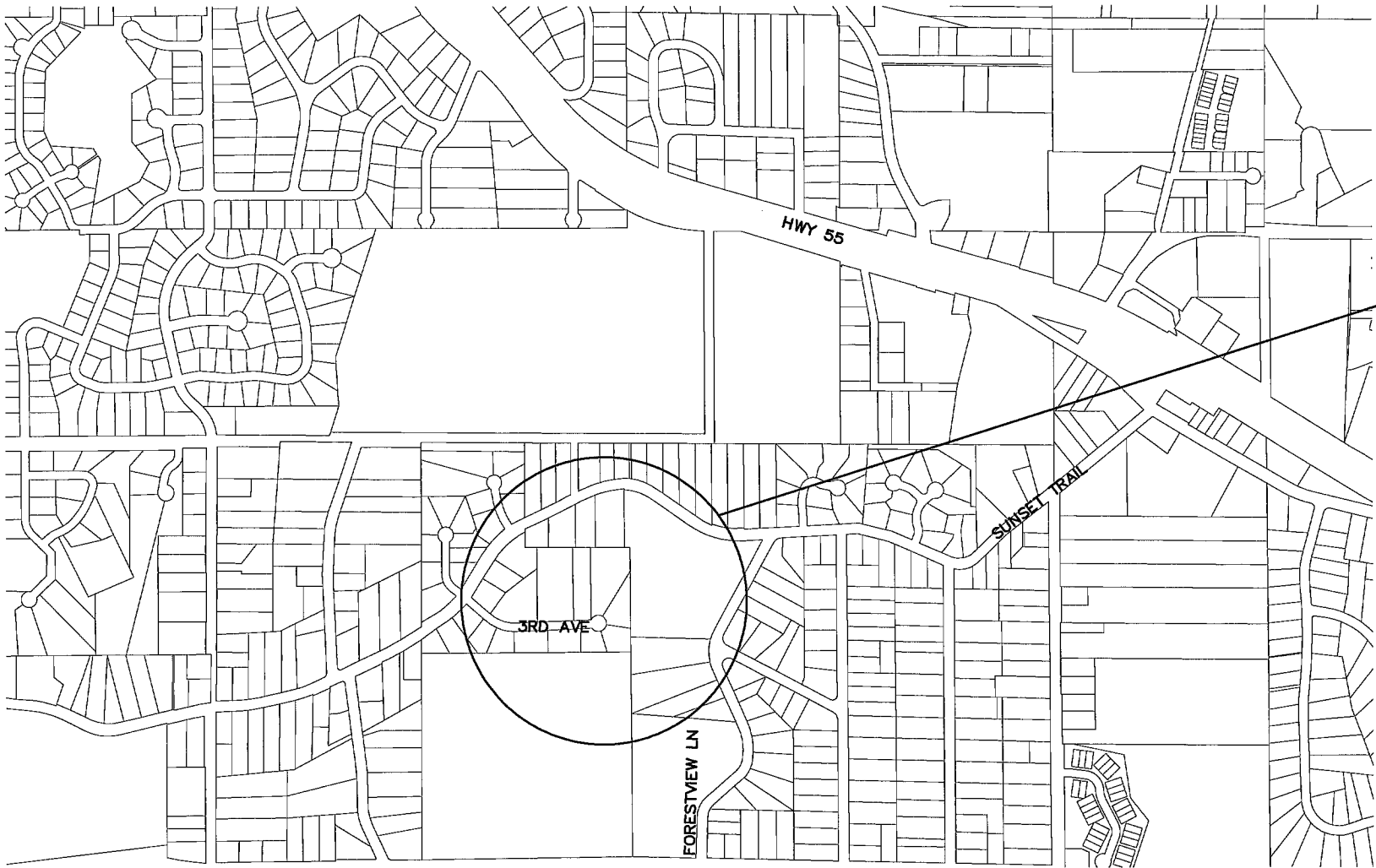

INDEX :

SHEET NO. DESCRIPTION

1 TITLE SHEET
2 LAYOUT & NOTES
3 DETAILS
4-5 PLAN & PROFILE

THIS PLAN SET CONTAINS 5 SHEETS

PROJECT AREA

GOVERNING SPECIFICATIONS:

THE 2005 EDITION OF THE MINNESOTA DEPARTMENT OF TRANSPORTATION THE MOST CURRENT, "STANDARD SPECIFICATIONS FOR CONSTRUCTION" THE MOST CURRENT CITY OF PLYMOUTH, "ENGINEERING GUIDELINES", AND THE CONTRACT DOCUMENTS, INCLUDING THE SPECIAL PROVISIONS, SHALL GOVERN. ALL APPLICABLE FEDERAL, STATE AND LOCAL LAWS AND ORDINANCES SHALL BE COMPLIED WITH IN THE CONSTRUCTION OF THIS PROJECT.

NOTE:

THE EXACT LOCATION OF UNDERGROUND UTILITIES SUCH AS GAS, TELEPHONE, WATER, ETC. ARE UNKNOWN. THE CONTRACTOR SHALL CONTACT THE APPROPRIATE UTILITIES BEFORE COMMENCING EXCAVATION.

SCALES :

PLAN _____ 50'
(PLAN) _____ 30'
PROFILE _____ 50'
HORIZ. _____ 30'
VERT. _____ 5'
X-SECTIONS _____ 10'
HORIZ. _____ 5'
VERT. _____ 5'

ENGR. _____
MICHAEL J. PAYNE, P.E., DESIGN MANAGER

Reg. No. _____ Date _____

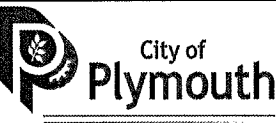

STATE AID
PROJ. NO.
CITY PROJ. NO.
12024

1
5

THE SUBSURFACE UTILITY INFORMATION IN THIS PLAN IS UTILITY LEVEL QUALITY D. THIS QUALITY LEVEL WAS DETERMINED ACCORDING TO THE GUIDELINES OF C/ASCE 38-02, ENTITLED "STANDARD GUIDELINES FOR THE COLLECTION AND DEPICTION OF EXISTING SUBSURFACE UTILITY DATA."

GOPHER STATE ONE CALL: (651) 454-0002

GENERAL NOTES

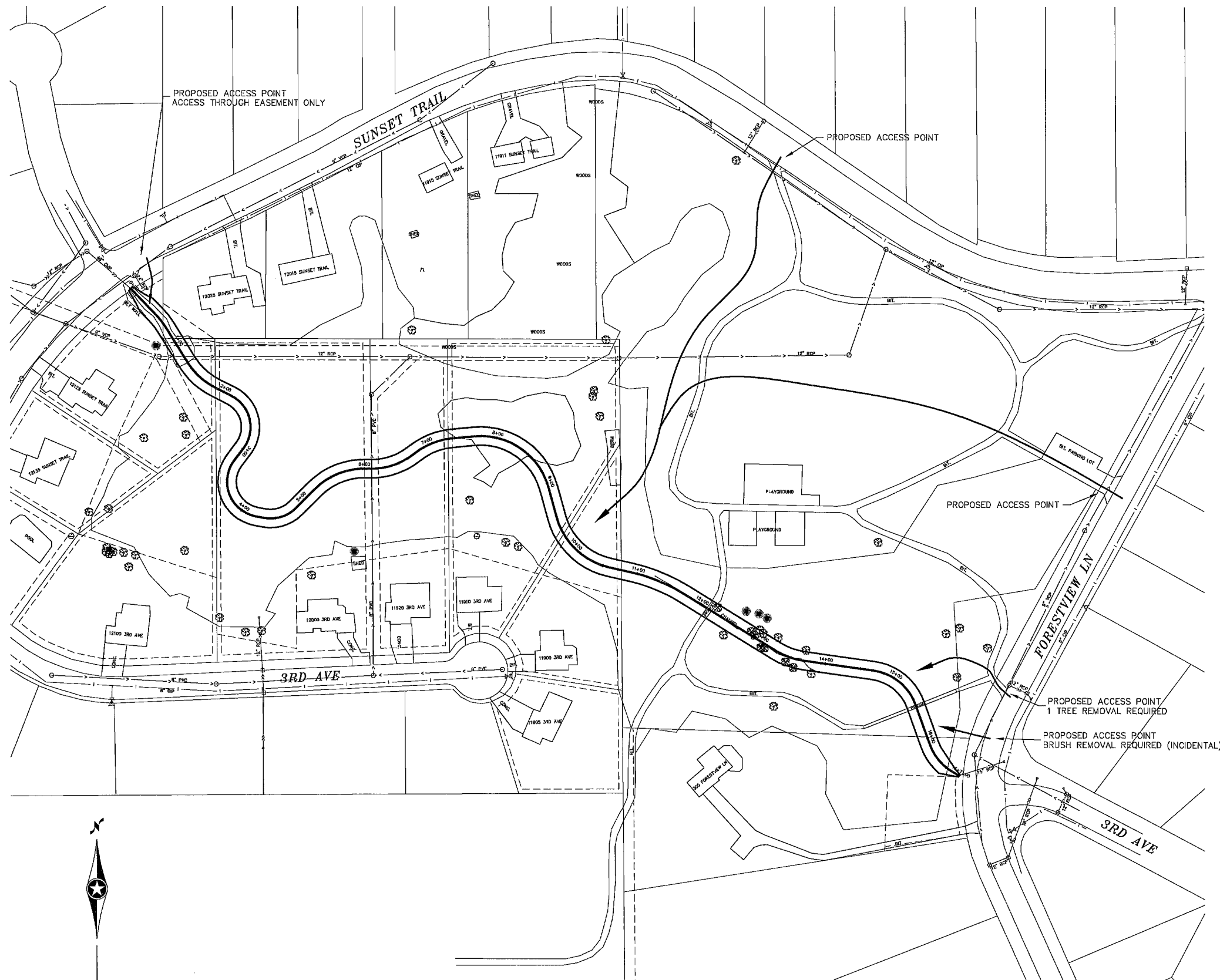

1. THE EXACT LOCATION OF UNDERGROUND UTILITIES SUCH AS GAS, TELEPHONE, WATER, ETC. ARE UNKNOWN. THE CONTRACTOR SHALL CONTACT GOPHER ONE CALL BEFORE COMMENCING ANY EXCAVATION
2. ALL EXCESS EXCAVATED MATERIAL IS THE PROPERTY OF THE CONTRACTOR.
3. CONTRACTOR MUST MAINTAIN EROSION CONTROL FOR ENTIRE PROJECT.
4. ACCESS TO LOCAL RESIDENCES MUST BE MAINTAINED AT ALL TIMES THROUGHOUT CONSTRUCTION
5. A MINIMUM OF 48 HRS. NOTICE IS REQUIRED FOR ALL STAKING REQUESTS.
6. THE MOST CURRENT CITY OF PLYMOUTH ENGINEERING STANDARD DETAIL SPECIFICATION FOR SEWER, WATER, STORM SEWER, & STREETS APPLY TO THIS PROJECT.
7. NO TREES OR SHRUBS ARE TO BE REMOVED UNLESS MARKED BY THE CITY OF PLYMOUTH FOR REMOVAL.
8. TRAFFIC CONTROL MUST BE PROPERLY MAINTAINED AT ALL TIMES IN ACCORDANCE WITH THE MNDOT TEMPORARY TRAFFIC CONTROL ZONE LAYOUTS BOOKLET.
9. ACTUAL EXCAVATION LOCATIONS SHALL BE MARKED IN FIELD BY ENGINEER.
10. CONTRACTOR SHALL PROTECT ALL EXISTING LANDSCAPING.
11. CONTRACTOR SHALL APPLY FOR NPDES PERMIT.
12. PROPOSED SITE ACCESS IS SHOWN ON PLAN. CONTRACTOR SHALL NEGOTIATE WITH HOMEOWNER IF DIFFERENT ACCESS IS DESIRED.
13. CHANNEL ALIGNMENTS TO BE STAKED BY CITY.
14. CONTRACTOR SHALL USE DESIGNATED PROJECT ACCESS POINTS UNLESS ALTERNATE ACCESS POINTS ARE APPROVED BY ENGINEER.
15. EXACT PROJECT ACCESS POINTS SHALL BE MARKED IN THE FIELD BY ENGINEER.
16. CONTRACTOR SHALL REMOVE AND REPLACE DAMAGED TRAIL SECTIONS AFTER EXCAVATION COMPLETION AS DIRECTED BY ENGINEER.
17. AN ESTIMATED 2,750 CY OF MATERIAL IS TO BE EXCAVATED.

[illegible]

I hereby certify that this plan, specification or report was prepared by me or under my direct supervision and that I am a duly Licensed Professional Engineer under the laws of the State of Minnesota.

Signature: _____
MICHAEL J. PAYNE

Date: 10-8-13 License#: 50484

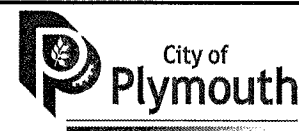

PLYMOUTH, MINNESOTA
ST. MARY'S
DRAINAGE IMPROVEMENT
CITY PROJECT NO. 12026

LAYOUT & NOTES

STATE AID	DRAWN BY	DATE
PROJ. NO.	M. PAYNE	9-13
	DESIGNED BY	
	M. PAYNE	9-13
DWG NAME	CHECKED BY	
	D. ASCHE	9-13
	REVIEWED BY	
STMARY	J. RENNEBERG	9-13

CITY OF PLYMOUTH[6"]

IMPROVEMENT PROJECT: [3"]
(PROJECT NAME) [3"]
(PROJECT NO.) [2-1/2"]

PROCEED WITH CAUTION [6"]

FOR INFORMATION CALL: [2-1/2"]
PROJECT HOTLINE NO. (763) 509-55XX [WHERE APPLICABLE]
PROJECT WEBSITE WWW.PLYMOUTH.MN.US [WHERE APPLICABLE]

(NAME OF CONSULTING ENGINEER) CITY ENGINEERING DIVISION:
(NAME OF PROJECT MANAGER) [2-1/2"] (CITY REPRESENTATIVE)
(PHONE NO.) PHONE NO. (763) 509-5500

(CONTRACTOR'S NAME) SCHEDULED COMPLETION DATE:
(ADDRESS) [2-1/2"] (DATE)
(LOCAL PHONE NO.)

NOTE:
Sign shall be 4' x 6' with a white background with black letters, (no hand lettering) and of proper height to be readily visible from an automobile, and located as directed by engineer. Sign shall be mounted on 4"x 4" posts

() Project Specific Information



STANDARD DETAILS
STANDARD CITY PROJECT SIGN
CITY OF PLYMOUTH

PUBLISHED
3-13
CITY PL. NO.
DWG-1
REVISED 3-11

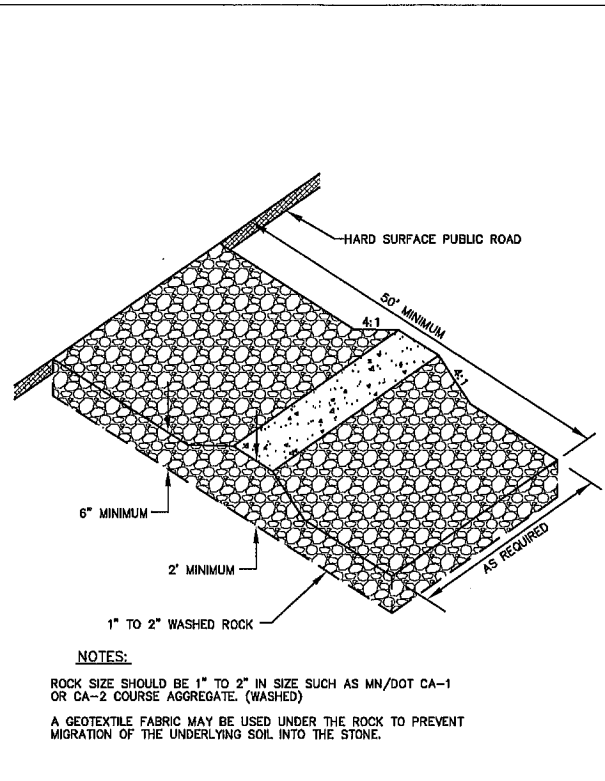

STANDARD DETAILS
ROCK ENTRANCE TO CONSTRUCTION SITE
CITY OF PLYMOUTH

PUBLISHED
3-13
CITY PL. NO.
ST-23
REVISED 3-11

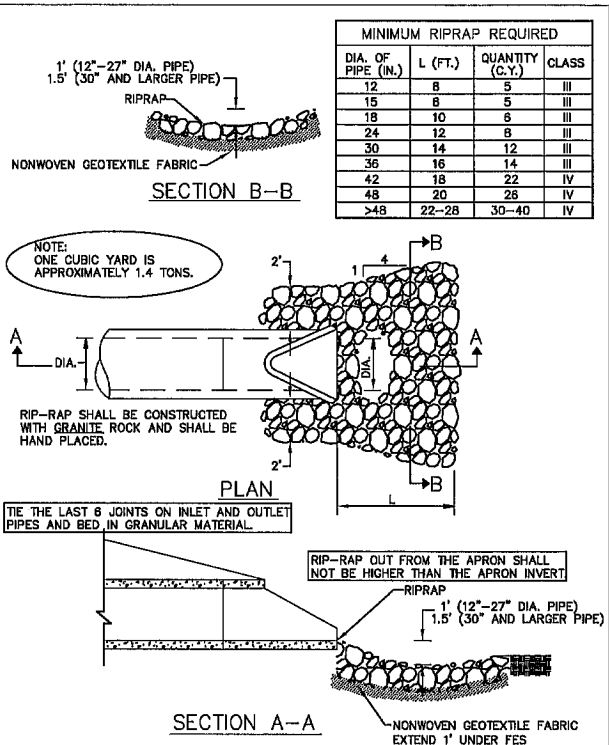

DIA. OF PIPE (IN.)	L (FT.)	QUANTITY (C.Y.)	CLASS
12	8	5	III
15	8	5	III
18	10	8	III
24	12	8	III
30	14	12	III
36	16	14	III
42	18	22	IV
48	20	26	IV
>48	22-28	30-40	IV

STANDARD DETAILS
RIPRAP DETAIL FOR FLARED END SECTIONS
CITY OF PLYMOUTH

PUBLISHED
3-13
CITY PL. NO.
ST-4
REVISED 3-12

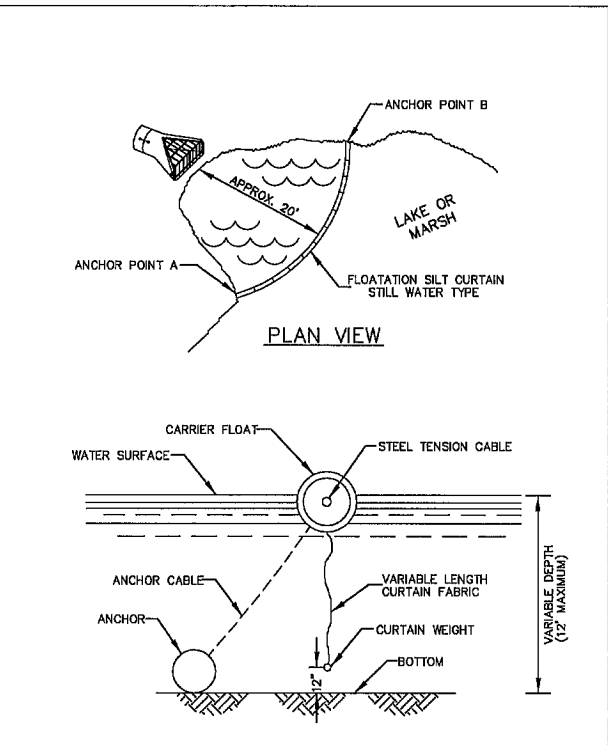

STANDARD DETAILS
FLOATATION SILT CURTAIN DETAIL
CITY OF PLYMOUTH

PUBLISHED
3-13
CITY PL. NO.
ST-21
REVISED 3-11

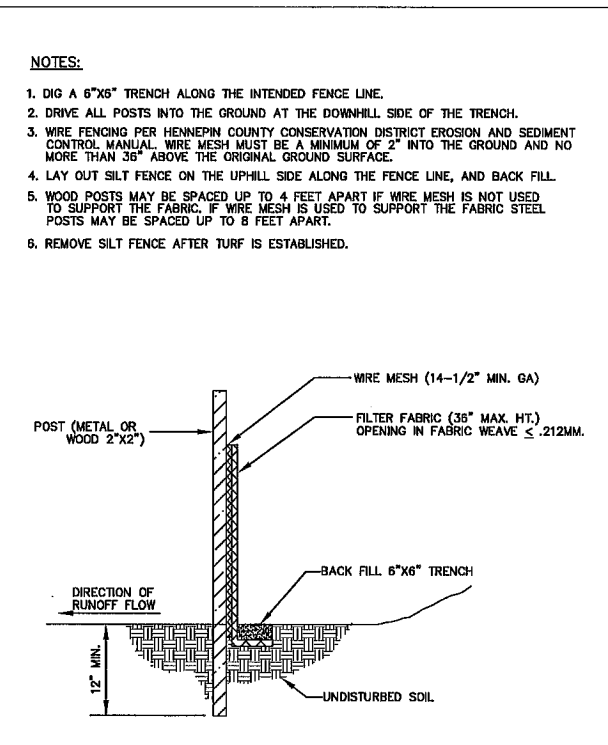

STANDARD DETAILS
SILT FENCE DETAIL
CITY OF PLYMOUTH

PUBLISHED
3-13
CITY PL. NO.
ST-22
REVISED 3-11

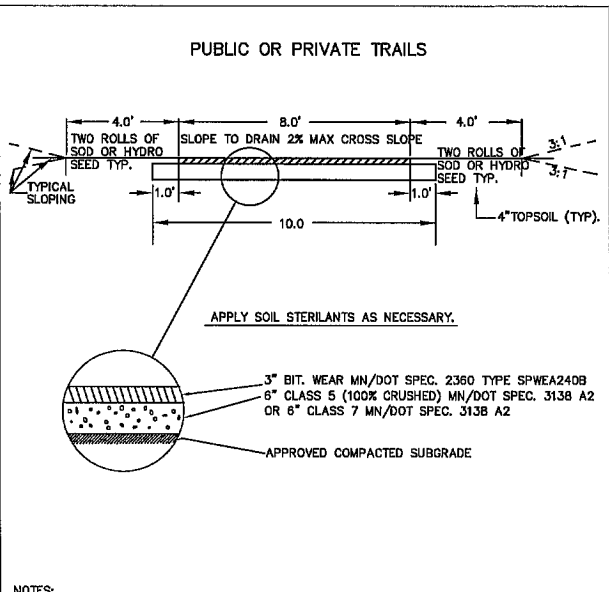

STANDARD DETAILS
TYPICAL TRAIL CROSS SECTION
CITY OF PLYMOUTH

PUBLISHED
3-13
CITY PL. NO.
STRT-14
REVISED 3-11

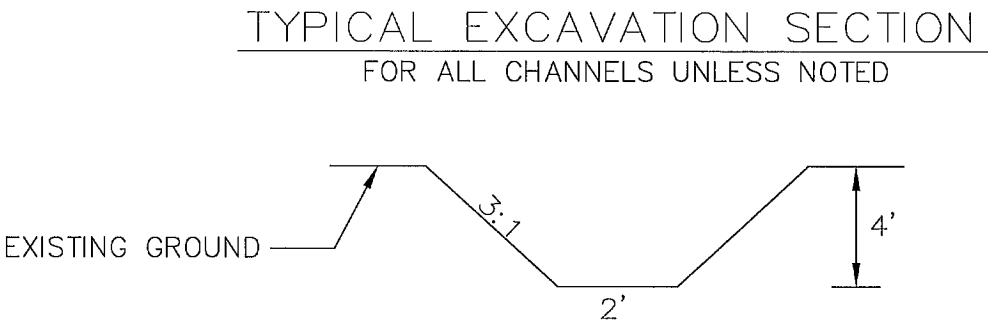

NO	DATE	BY	CKD	APPR	REVISION

I hereby certify that this plan, specification or report was prepared by me or under my direct supervision and that I am a duly Licensed Professional Engineer under the laws of the State of Minnesota.

Signature: MICHAEL J. PAYNE
Date: 10-8-13 License#: 50484

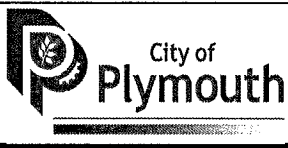

PLYMOUTH, MINNESOTA
ST. MARY'S
DRAINAGE IMPROVEMENT
CITY PROJECT NO. 12026

DETAILS

STATE AID PROJ. NO.	DRAWN BY M. PAYNE	DATE 9-13
DWG NAME	DESIGNED BY M. PAYNE	9-13
STMARY	CHECKED BY D. ASCHE	9-13
	REVIEWED BY J. RENNEBERG	9-13

EX BM ELEVATION 917.95
TNH ON S. SIDE OF 510 JONQUIL LN
ON N. SIDE OF SUNSET TRAIL

NOTE:
THE EXACT LOCATION OF UNDERGROUND UTILITIES
SUCH AS GAS, TELEPHONE, WATER, ETC., ARE UNKNOWN.
THE CONTRACTOR SHALL CONTACT GOPHER ONE-CALL
BEFORE COMMENCING ANY EXCAVATION.

(21) DENOTES EXISTING STRUCTURE NUMBER
(SEE EXISTING STRUCTURE SCHEDULE)

MAINTAIN LOCAL ACCESS
AT ALL TIMES

ALL GATE VALVES ARE TO BE
OPERATIONAL AT ALL TIMES

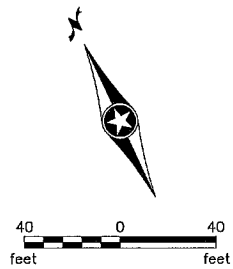

NOTE:
CHANNEL SIDE SLOPES SHALL BE 2:1 INSTEAD OF 3:1 FROM STATIONS 0+00 TO
STATION 1+25 AS DIRECTED BY ENGINEER.

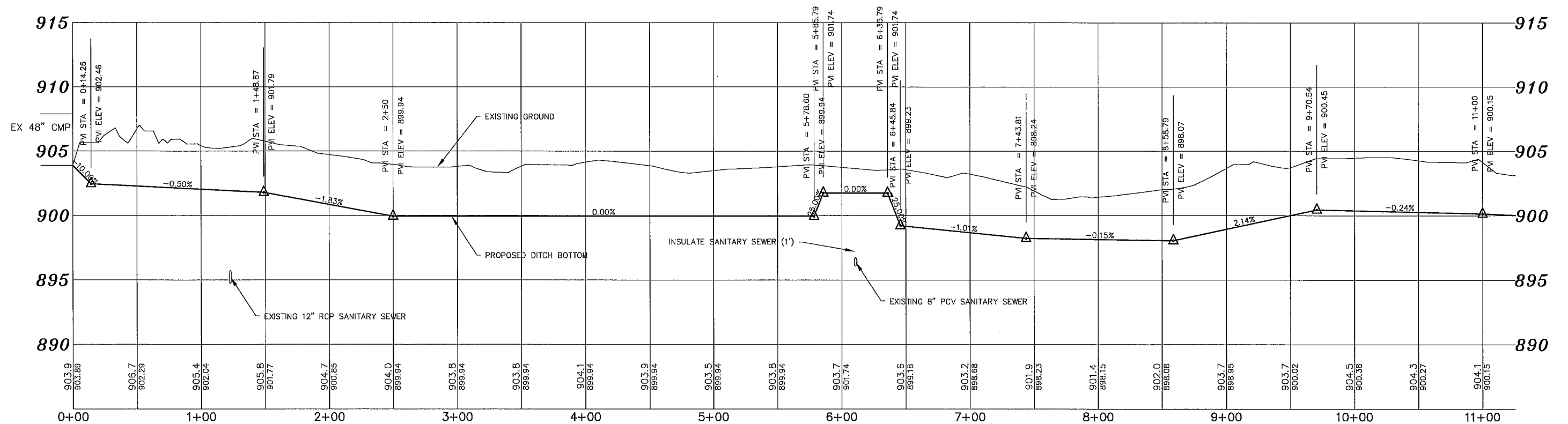
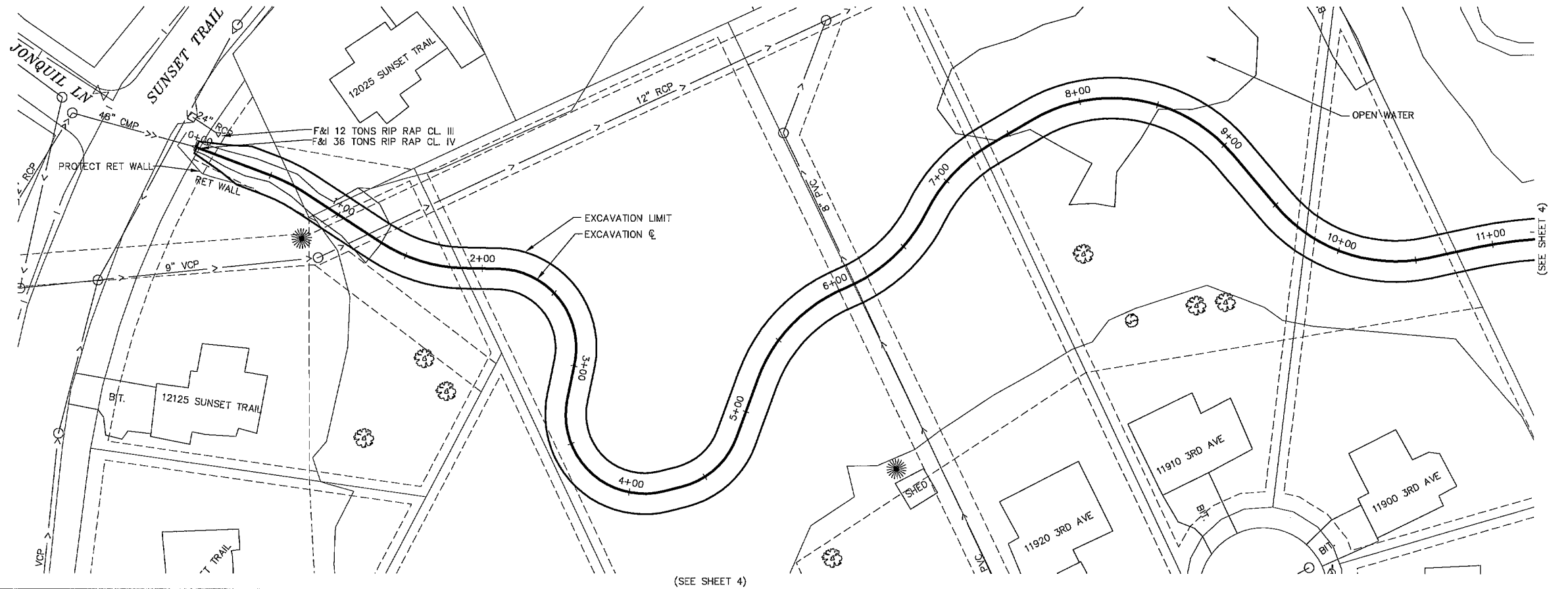

NO	DATE	BY	CKD	APPR	REVISION

I hereby certify that this plan, specification or report was prepared by me or under my direct supervision and that I am a duly Licensed Professional Engineer under the laws of the State of Minnesota.

Signature: MICHAEL J. PAYNE

Date: 10-8-13 License#: 50484

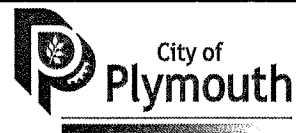

PLYMOUTH, MINNESOTA
ST. MARY'S
DRAINAGE IMPROVEMENT
CITY PROJECT NO. 12026

PLAN & PROFILE

STATE AID PROJ. NO.	DRAWN BY M. PAYNE	DATE 9-13
DWG NAME	DESIGNED BY M. PAYNE	9-13
STMARY	CHECKED BY D. ASCHE	9-13
	REVIEWED BY J. RENNEBERG	9-13

4

5

EX BM ELEVATION 910.87
TNH AT 330 FORESTVIEW LN

NOTE:
THE EXACT LOCATION OF UNDERGROUND UTILITIES
SUCH AS GAS, TELEPHONE, WATER, ETC., ARE UNKNOWN.
THE CONTRACTOR SHALL CONTACT COPHER ONE-CALL
BEFORE COMMENCING ANY EXCAVATION.

MAINTAIN LOCAL ACCESS
AT ALL TIMES

✱ DENOTES TREE TO BE REMOVED

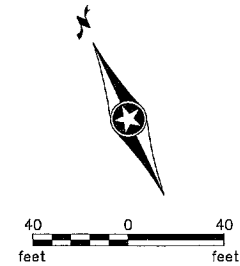

NOTE:
CHANNEL SIDE SLOPES SHALL BE 2:1 INSTEAD OF 3:1
FROM STATIONS 12+00 TO STATION 13+50 AS
DIRECTED BY ENGINEER.

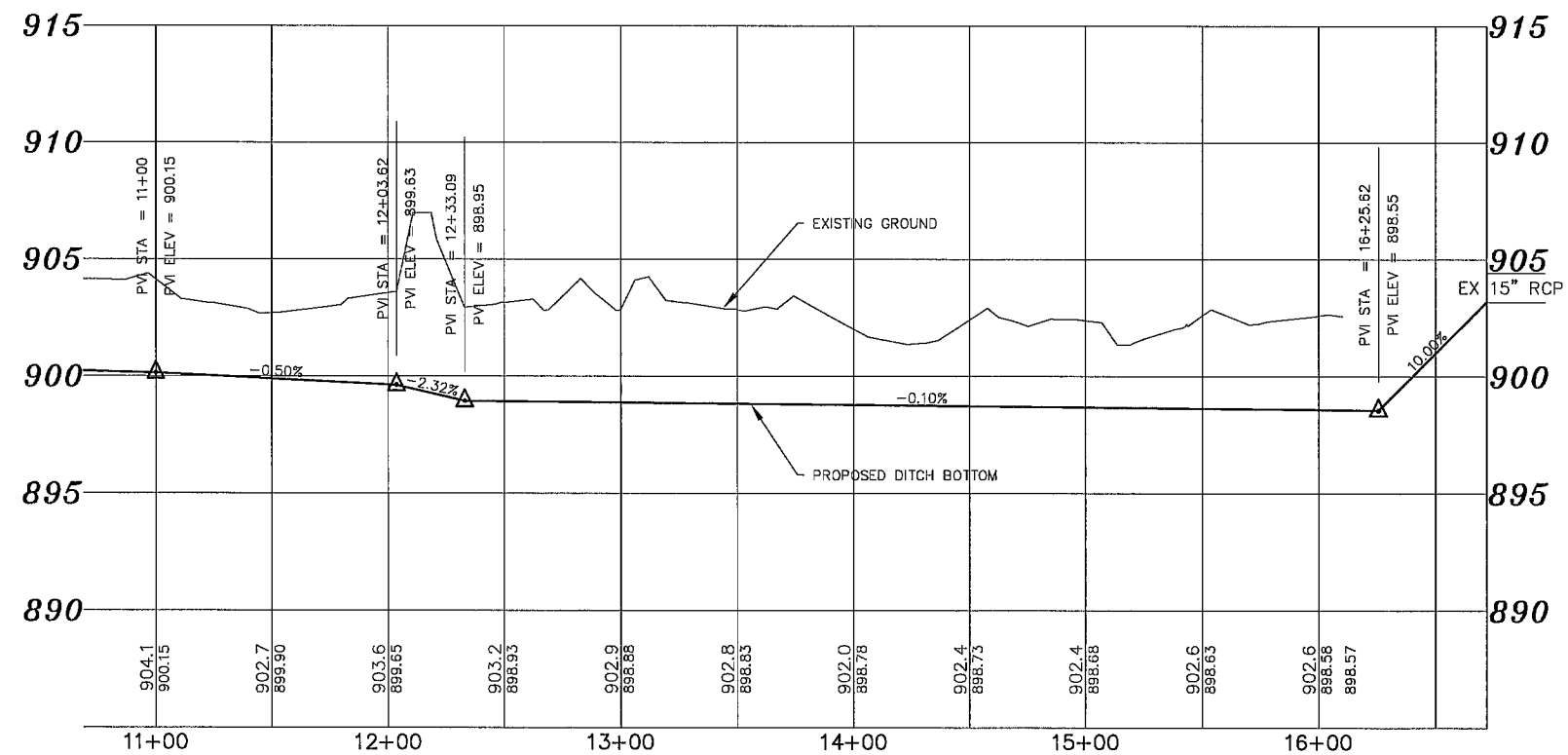
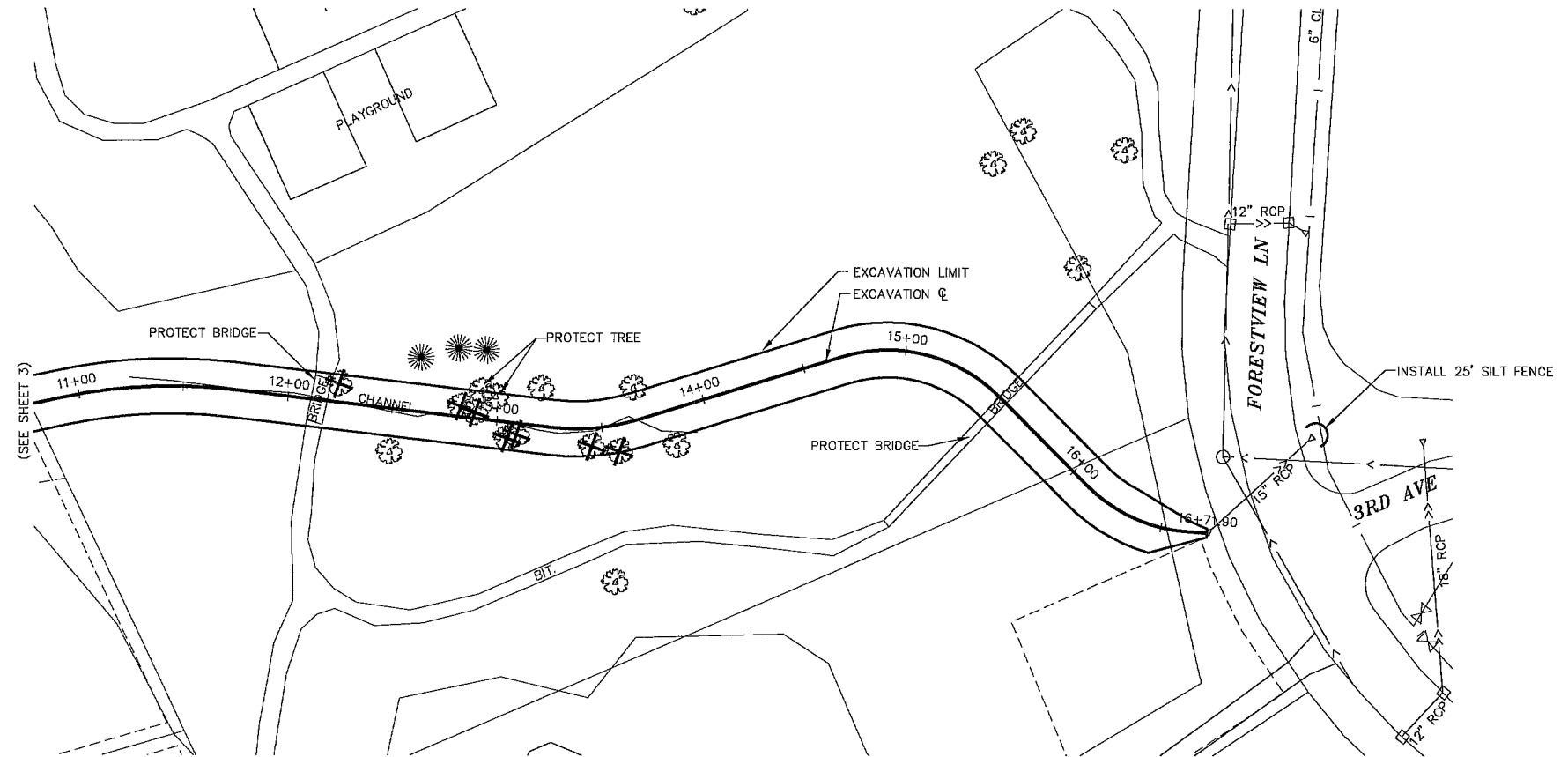

NO	DATE	BY	CKD	APPR	REVISION

I hereby certify that this plan, specification or report was prepared by me or under my direct supervision and that I am a duly Licensed Professional Engineer under the laws of the State of Minnesota.

Signature: MICHAEL J. PAYNE

Date: 10-8-13 License#: 50484

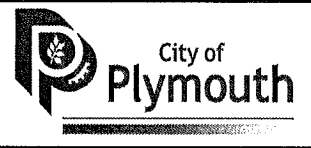

PLYMOUTH, MINNESOTA
ST. MARY'S
DRAINAGE IMPROVEMENT
CITY PROJECT NO. 12026

PLAN & PROFILE

STATE AID PROJ. NO.	DRAWN BY M. PAYNE	DATE 9-13
DWG NAME	DESIGNED BY M. PAYNE	9-13
STMARY	CHECKED BY D. ASCHE	9-13
	REVIEWED BY J. RENNEBERG	9-13